

HYUNDAI
POWER PRODUCTS

PETROL LAWNMOWER
HYM430SP
HYM460SP
HYM510SP

User Manual

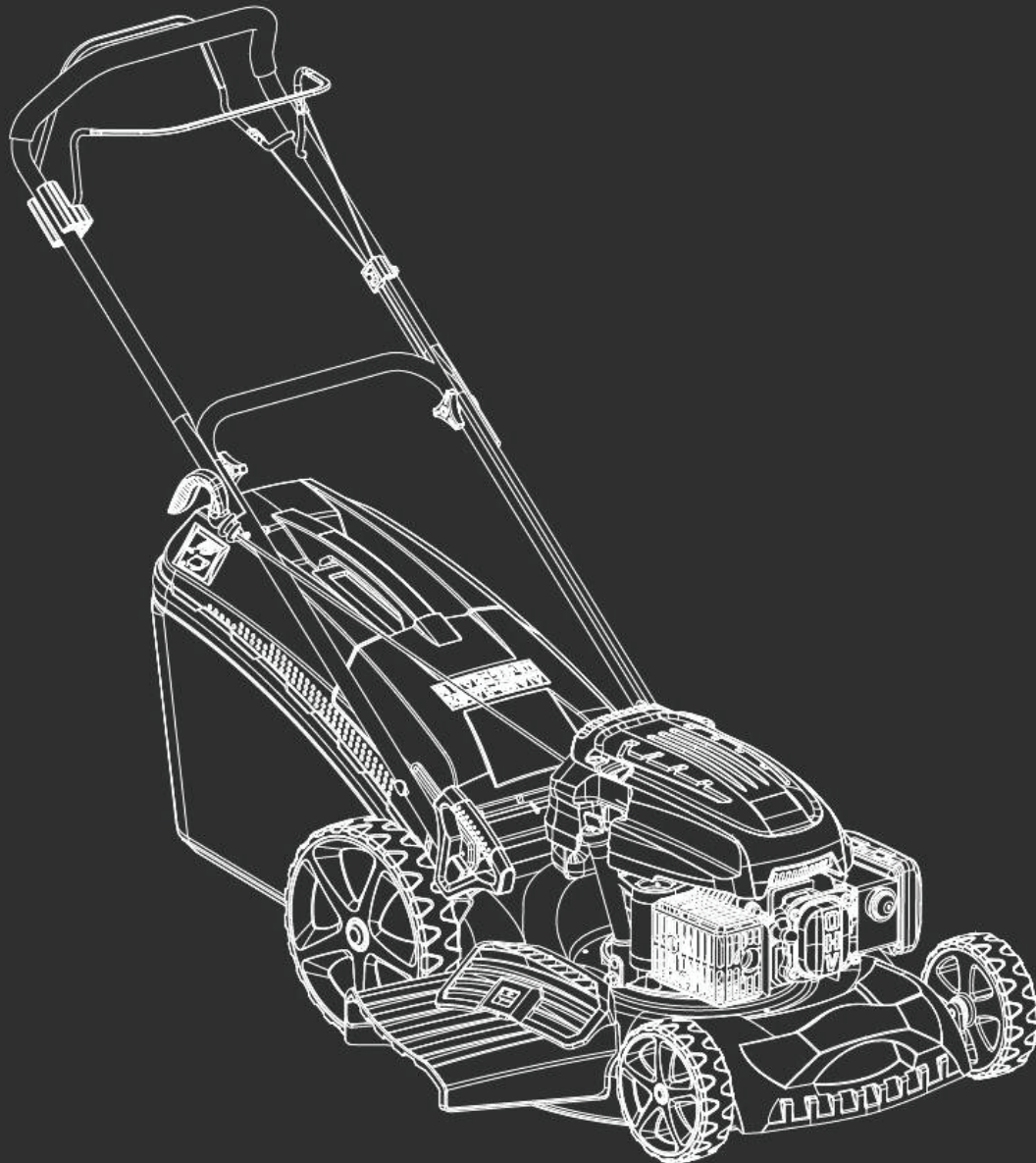

INDEX

| | CONTENTS | PAGE NO.S |
|----|--------------------|------------------|
| 1 | SAFETY | 3 - 7 |
| 2 | PART LOCATIONS | 8 |
| 3 | QUICK START GUIDE | 9 - 15 |
| 4 | STARTING PROCEDURE | 15 - 16 |
| 5 | STOPPING PROCEDURE | 16 |
| 6 | USING THE MACHINE | 17 - 18 |
| 7 | MAINTENANCE | 18 - 22 |
| 8 | TROUBLESHOOTING | 23 |
| 9 | SPECIFICATION | 24 |
| 10 | CONTACT DETAILS | 25 |
| 11 | WARRANTY | 25 |

1. SAFETY

1.1 General Safety Notes.

- 1.2 The operator of the machine is responsible for, and has a duty of care in making sure that the machine is operated safely and in accordance with the instructions in this user manual. Keep the manual safe and pass it on if the machine is loaned or sold to another user.
- 1.3 Please note the following safety points.
- 1.4 The machine should never be left in a condition which would allow an untrained or unauthorised person/s to operate this machine.
- 1.5 All due care and diligence should be taken by the operator for the safety of and with regard to those around whilst using the machine.
- 1.6 Some or all of the following - warning signs, symbols and/or PPE pictograms may appear throughout this manual. You **MUST** adhere to their warnings. Failure to do so may result in personal injury to yourself or those around you.



DANGER

Indicates a hazard, which, if not avoided, could result in serious injury or death.



WARNING

Indicates a hazard, which, if not avoided, could result in serious injury.



CAUTION

Indicates a hazard which, if not avoided, might result in minor or moderate injury.



NOTE

Indicates a situation that could easily result in equipment damage.

READ and keep the manual safe and pass it on if the machine is loaned or sold to another user.

You **MUST** fully understand all instructions to ensure you use and operate the machine safely.

Appropriate Personal Protective Equipment (PPE), **MUST** be worn at all times when operating or repairing the machine.



HAND
PROTECTION
MUST BE WORN



EYE
PROTECTION
MUST BE WORN



PROTECTIVE
CLOTHING
MUST BE WORN



HEARING
PROTECTION
MUST BE WORN



FOOT
PROTECTION
MUST BE WORN



HEAD
PROTECTION
MUST BE WORN



RESPIRATOR
MUST BE WORN



FACE SHIELD
MUST BE WORN



1.10 Carbon Monoxide (where applicable).

- 1.11 Carbon monoxide is a colourless and odourless gas. Inhaling this gas can cause death as well as serious long term health problems such as brain damage.
- 1.12 The symptoms of carbon monoxide poisoning can include but are not limited to the following;
Headaches, dizziness, nausea, breathlessness, collapsing or loss of consciousness.
- 1.13 Carbon monoxide poisoning symptoms are similar to flue, food poisoning, viral infections and simply tiredness. It is quite common for people to mistake this very dangerous poisoning for something else.
- 1.14 To avoid carbon monoxide poisoning **DO NOT** use Petrol/Diesel powered equipment inside any of the following; Home, garage, tent, camper van, mobile home, caravan or boat. This is not exhaustive and if you are in any doubt contact your dealer.
- 1.15 If you think you have or someone around you has been affected by carbon monoxide poisoning;
- 1.16 Get them fresh air immediately, by leaving the affected area or by opening doors and windows. If safe and practical to do so make sure that the machine is turned off. **DO NOT** enter a room you suspect of having carbon monoxide present – instead call the emergency services.
- 1.17 Contact a Doctor immediately or go to Hospital – let them know that you suspect carbon monoxide poisoning.
- 1.18 **DO NOT** use in an enclosed area or moving vehicle.

1.20 General Fuel Safety (where applicable).



CAUTION

ALL FUELS ARE FLAMABLE

- 1.21 Fire Hazard – keep fuel away from all sources of ignition for example heaters. Lamps, sparks from grinding or welding.
- 1.22  **DO NOT** carry out hot work on tanks that have contained fuel.
- 1.23 **ALWAYS** keep the work area tidy.
- 1.24 **ALWAYS** clean up spills promptly using absorbent granules and a lidded bin.
- 1.25 **ALWAYS** dispose of waste fuels correctly.

1.30 Fueling/De-fueling (where applicable).



CAUTION

ALL FUELS ARE FLAMABLE

1.31 **ALWAYS** fuel and defuel in a well ventilated area outside of buildings.

1.32 **ALWAYS** wear correct, suitable and fit for purpose Personal Protective Equipment (PPE), suggested items are but not limited to safety gloves, overalls.



1.33 When fueling/de-fueling **ALWAYS** avoid inhaling fumes.

1.34 When de-fueling **ALWAYS** use a proper fuel retriever.



1.35 **ALWAYS** carry fuel in the correct and clearly marked container.

1.40 **Electrical Safety (where applicable).**

1.41 Electricity can kill – **NEVER** work on **LIVE/ENERGISED** equipment.

1.42 Prior to carrying out any maintenance work you **MUST** identify electrical isolation methods and isolate all electrical supplies.

1.43 Prior to use and with all electrical supplies isolated, you **MUST** check all electrical cables, plugs and connectors for the following;

1.44 Are intact and have no signs of damage, to include but not limited to bare wires, chaffing, cuts and loose wiring.

1.45 If there are any signs of damage, the damage item **MUST** be taken out of service until the damage has been repaired by an electrically competent person.

1.46 All trailing cables should be routed so as not to cause any kind of trip hazard.

1.47 **NEVER** work on or near electricity with wet hands, wet clothing and wet gloves.



1.50 Batteries (where present).

- 1.51 Batteries present a risk if they become damaged by the possible leaking of electrolyte. This electrolyte is an acid and can cause serious burn injuries. Care should be taken when working on or near them. **NOTE** the electrolyte may be in a liquid or gel form.
- 1.52 Should you come in to contact with electrolyte you should;
- 1.53 Remove all clothing contaminated with electrolyte. If you cannot remove then saturate them in water.
- 1.54 Get medical assistance as soon as possible. You must advise the medical staff of the type of acid.
- 1.55 Lead/acid battery = dilute sulphuric acid.
- 1.56 Nickel/cadmium = potassium hydroxide alkali electrolyte.
- 1.57 Use fresh running water to wash off excess electrolyte, continue this until medical assistance arrives. Make sure that you do not wash the electrolyte to another part of your body or face.
- 1.58 If electrolyte comes in to contact with Eyes the electrolyte needs to be immediately washed away with large amounts of water. Make sure that you do not wash the electrolyte to another part of your face or body.
- 1.59 Gasses from charging batteries are highly flammable and great care should be taken to charge in well ventilated areas.
- 1.59.1  There is an explosion risk if the battery terminals are short circuited, when connecting/disconnecting **ALWAYS** exercise great care so that the terminals or battery leads are **NOT** allowed to touch and cause a spark. **ALWAYS** use suitable insulated tools.

1.60 Vibrations (where applicable).

- 1.61 Prolonged use of hand held (operated) machines will cause the user to feel the effects of/from vibrations. These vibrations can lead to white finger (Raynaud's phenomenon) or carpal tunnel syndrome. This condition reduces the ability of the hand to feel and regulate temperature, causing numbness and heat sensations and may cause nerve damage and circulatory tissue death.
- 1.62 Not all factors that lead to white finger disease are known, but cold weather, smoking and other diseases that affect blood vessels and blood circulation as well as large and long-lasting impact of shocks are considered factors in the formation of white finger. Note the following to reduce the risk of white finger and carpal tunnel syndrome;
- 1.63 Wear gloves and keep your hands warm.
- 1.64 Take regular breaks.
- 1.65 All of the above precautions may help reduce the risk of white finger disease but not rule out the carpal tunnel syndrome. Long-term and regular users are therefore recommended to observe the condition of your hands and fingers. Seek medical attention immediately if any of the above symptoms should occur.

1.70 Noise (where applicable).

1.71 The operating noise of the machine can damage your hearing. Wear hearing protection such as earplugs or ear defenders to protect your hearing. Long-term and regular users are advised to have hearing checked regularly. Be especially vigilant and cautious when hearing ear protection because your ability to hear alarm warnings will be reduced.

1.72 Noise emissions for this equipment is unavoidable. Carry out noisy work at approved times and for certain periods. Limit the working time to a minimum. For your personal protection and protection of people working nearby it is also advisable for them to wear hearing protection.

1.73 See Certificate of Conformity section for Outdoor Noise declaration of conformity.



2. PART LOCATIONS

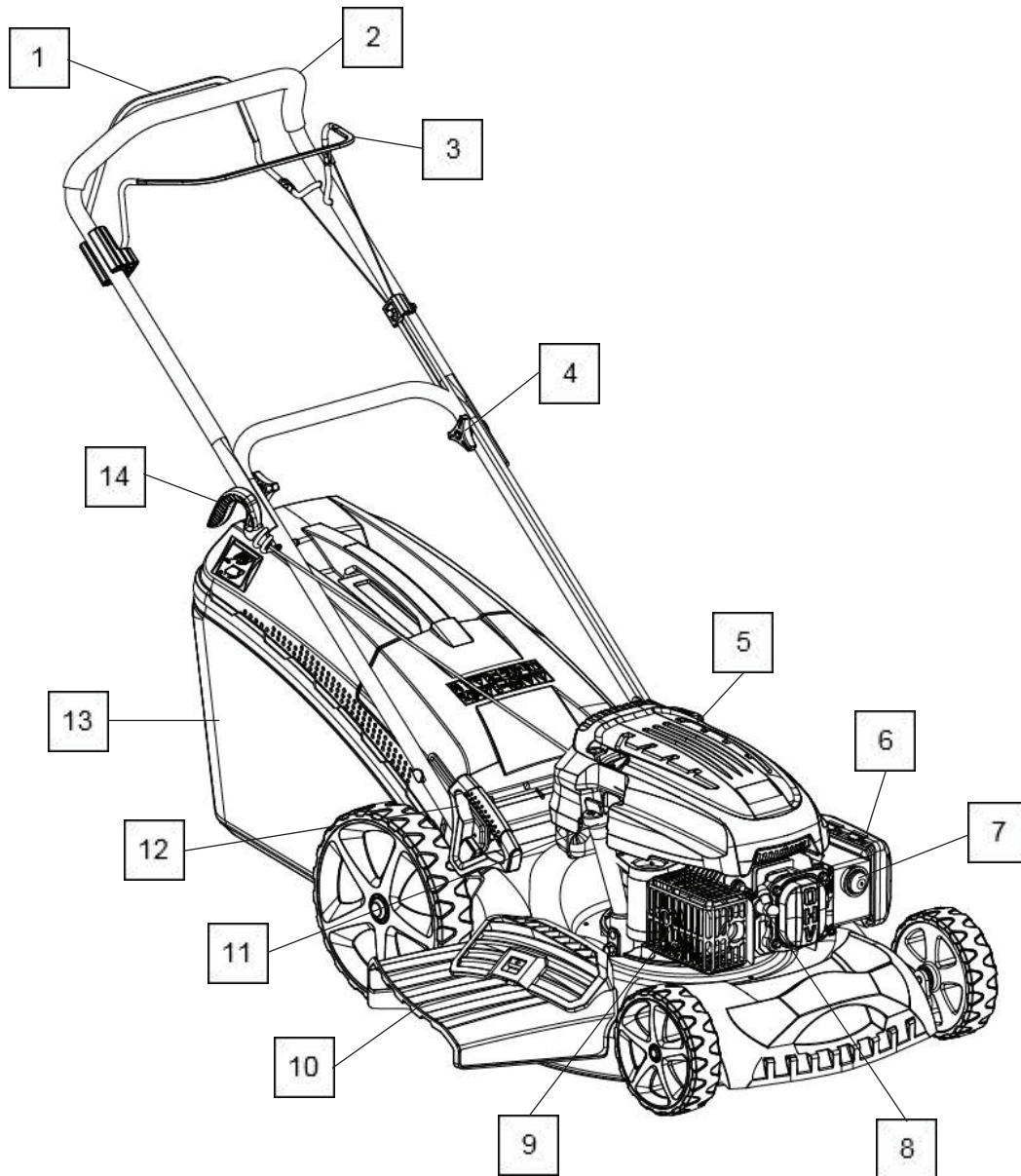

| | |
|----|---------------------------------|
| 1 | Drive Control Lever |
| 2 | Handlebar |
| 3 | Operator Presence Control Lever |
| 4 | Quick Release Hand Wheel |
| 5 | Fuel Filler Cap |
| 6 | Air Filter |
| 7 | Primer Bulb |
| 8 | Spark Plug |
| 9 | Exhaust |
| 10 | Side Discharge Chute* |
| 11 | Oil Filler/Dipstick |
| 12 | Central Cutting Height Adjuster |
| 13 | Grass Collector |
| 14 | Recoil Starter Handle |

* Not Available On All Models

3. QUICK START GUIDE

CAUTION

This guide is meant to serve as a quick reference for operating your Hyundai Lawn Mower.

We always advise reading the manual in full before operation.

CAUTION

For **OUTDOOR** use **ONLY**.

Petrol lawnmowers produce carbon monoxide – a poisonous, colourless and odourless gas that can cause serious injury or death.

Petrol is highly flammable, always handle with extreme care and in a well ventilated area.

NOTE

Images may vary depending on model.

If the lawnmower has the mulching option, **the mulching plug may already be installed for transport.**

GRASS COLLECTION MOWING

- 2.0 Lift the rear cover (1).
- 2.1 Remove the mulch plug if fitted (2).
- 2.2 Attach the grass catching bag (3).

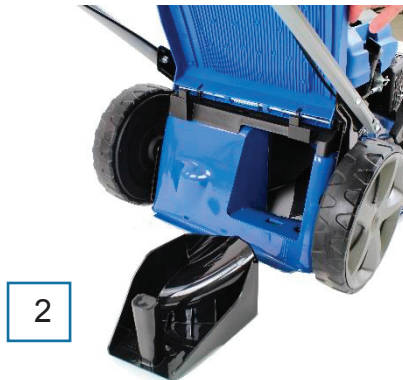

- 2.3 Attach the base of the handle to the mower (4) and tighten bolts securely.
- 2.4 Attach the upper handle to the lower handle (5) and tighten bolts securely.
- 2.5 Slowly pull the recoil cord and thread it through the cord loop (6).



- 2.6 Remove the oil filler cap (7) and fill with fresh 15W-40 engine oil to the upper mark (8) on the dipstick.
DO NOT overfill.
- 2.7 Once the correct amount of oil has been added, refit the dipstick securely.
- 2.8 If you overfill the oil, you can remove some by gently tilting the machine on its side and pouring out any excess oil into a suitable container.

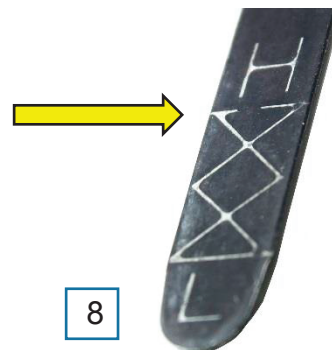

- 2.9 Remove the fuel tank cap (9).
- 2.10 Fill the fuel tank with fresh straight unleaded petrol. Allow a 25mm gap from the top of the tank, then refit the cap securely.
- 2.11 **DO NOT** mix petrol with oil and clean up any spills immediately.



MULCHING MODE

- 2.12 For mulching mode, lift the rear flap and remove the grass box (1).
- 2.13 Install the mulching plug (2) and lower the rear cover (3).



SIDE DISCHARGE

- 2.14 Carry out the steps in 2.12 & 2.13.
- 2.15 Lift the side flap (1).
- 2.16 Insert the side discharge chute (2).
- 2.17 Allow the spring loaded side flap to rest on the discharge chute (3).



CABLE ATTACHMENT



NOTE

If you are stood behind the lawn mower:

OPC Cable: This attaches to the lever in front of the main handlebar and if followed, will attach to the engine.

Drive Cable: This attaches to the lever behind the main handlebar and if followed, will enter the deck of the lawn mower behind the engine.

- 2.18 Follow the cable you want to attach and determine which lever it will attach to (1).
2.19 Gently prise the lever from its locating hole in the main handlebar (2).

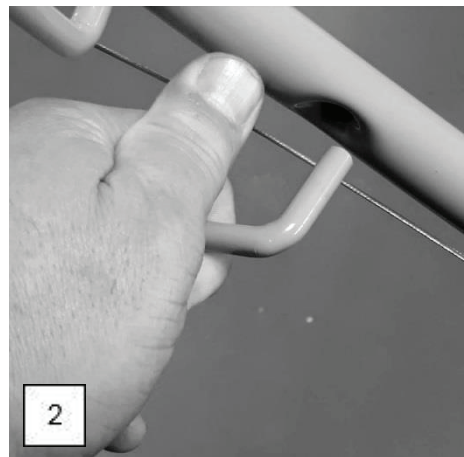
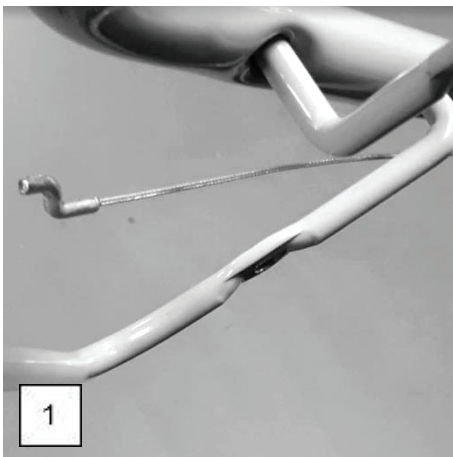

- 2.20 Insert the end of the cable in to the location hole on the lever (3).
2.21 Follow the curve of the cable until it lies flat in the lever (4).

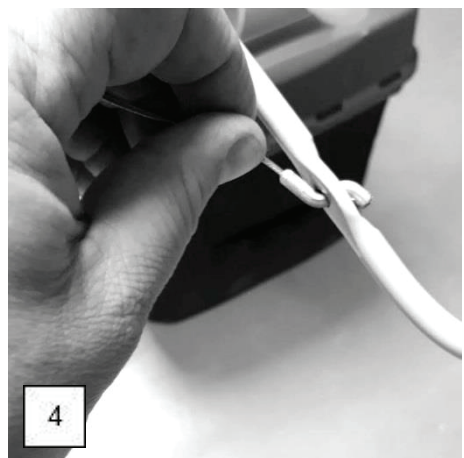
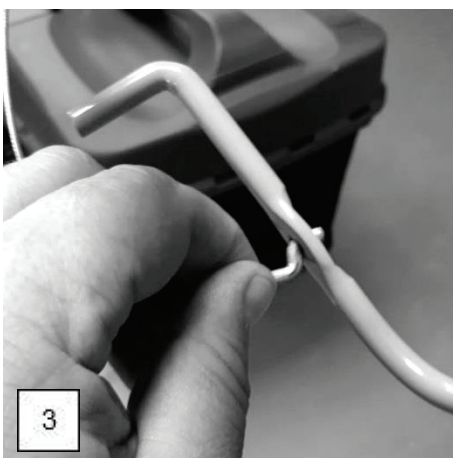

- 2.22 Refit the lever back into its location hole on the main handlebar (5).
- 2.23 Check the cable lies flat and has not snagged on any other part of the lawnmower (6).

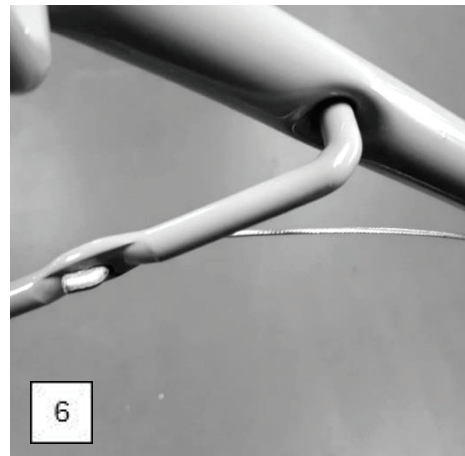
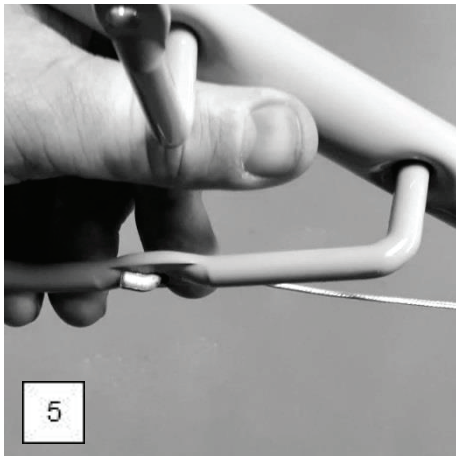

OPC CABLE ADJUSTMENT



NOTE

It is necessary as part of routine maintenance to adjust the OPC cable tension to ensure the lawnmower will start correctly.

- 2.24 If there is more than 10mm movement in the OPC lever before the cable begins to move, then the OPC cable will require adjustment.
- 2.25 Follow the OPC cable to the adjuster located on the side of the engine (1).
- 2.26 Undo the lock nut and wind it forwards (2).

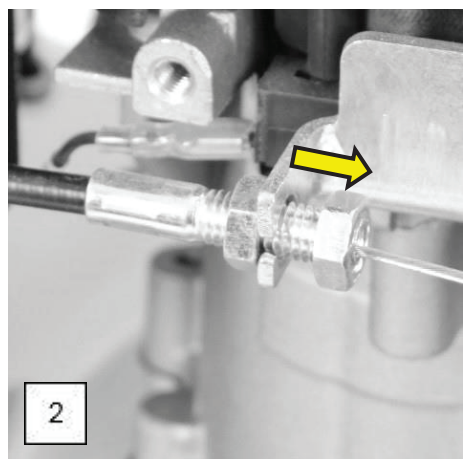
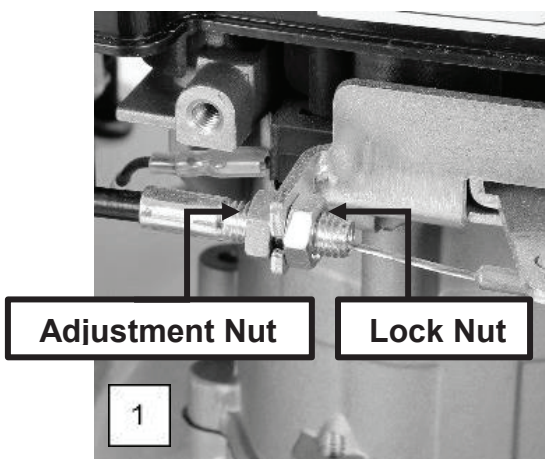

- 2.27 Move the adjustment nut towards the lock nut and continually check the cable tension at the lever (3).

- 2.28 Once the movement has been removed, hold the adjustment nut in place and tighten the lock nut back towards the adjustment lever to lock the cable in place (4).

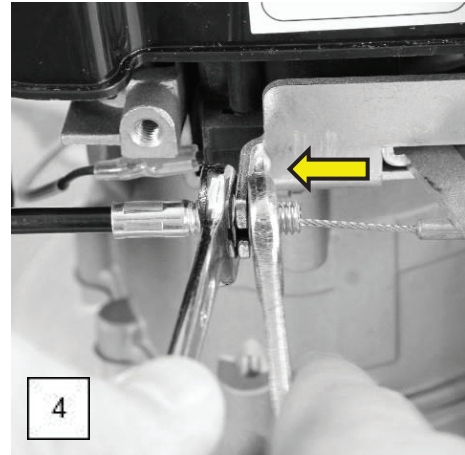
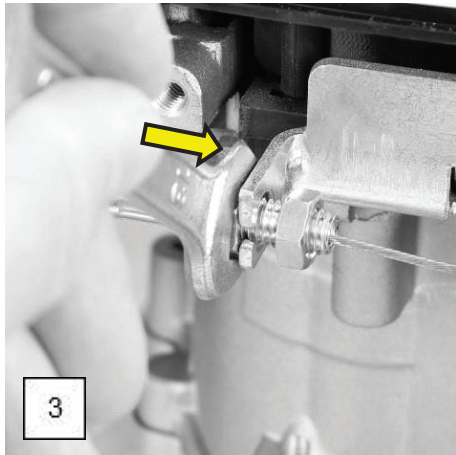

- 2.29 Check the cable adjustment has worked by starting the mower. If the mower still fails to start, re-adjust until the lawnmower starts.

DRIVE CABLE ADJUSTMENT



NOTE

It is necessary as part of routine maintenance to adjust the drive cable tension to ensure the lawnmower will self-propel correctly.

- 2.30 If there is more than 10mm movement in the drive lever before the cable begins to move, then the drive cable will require adjustment.
- 2.31 Follow the drive cable down towards the lawnmower until you reach the drive cable adjuster (1).
- 2.32 Undo the lock nut and wind it forwards (2).

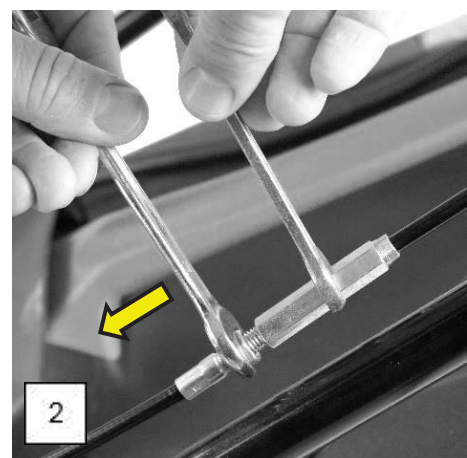
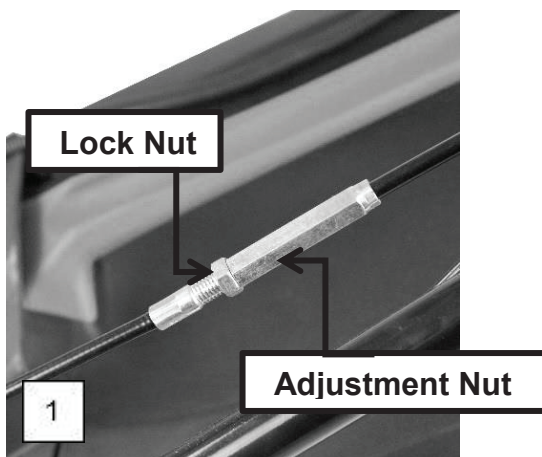

- 2.33 Wind the adjuster nut towards the main handlebar. As you adjust, keep checking the tension on the drive cable until the desired tension is reached (3).

- 2.34 Tighten the lock nut finger tight, back towards the adjuster nut and check for drive on the lawn mower.
Once drive is restored, tighten the lock nut securely (4).

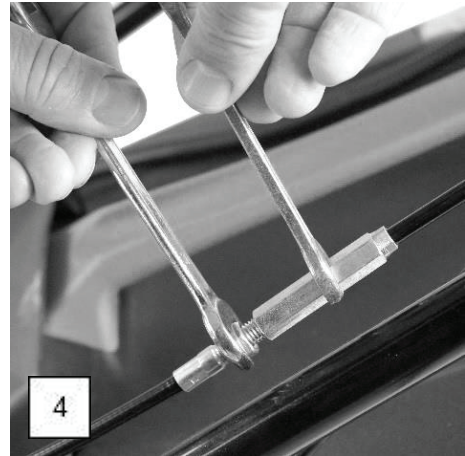
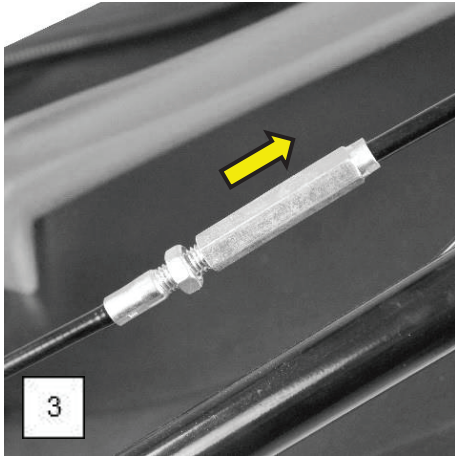

4. STARTING PROCEDURE

NOTE

You **MUST** ensure the mower has the correct oil and fuel level before operation.

- 3.0 From cold, pump the primer bulb (1) 5 times.
- 3.1 Make sure the blade is free of long grass and the cutting height is set to maximum (2).

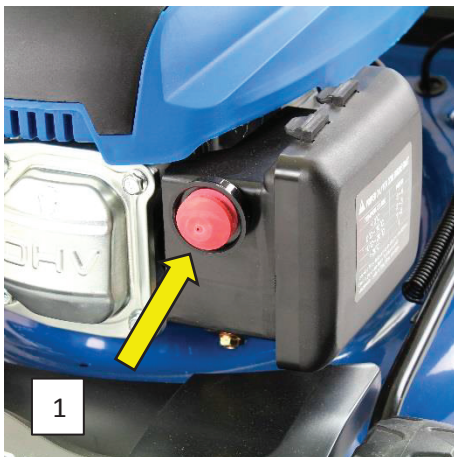

- 3.2 Pull back the Operator Presence Control (OPC) lever (3) towards the main handle.
- 3.3 Pull the recoil starter handle (4) swiftly – repeat until the engine starts.

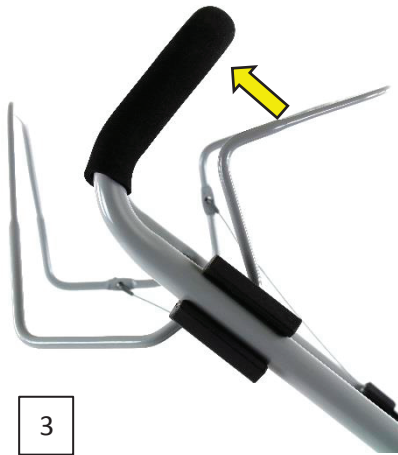

5. STOPPING PROCEDURE

CAUTION

The engine and exhaust will remain hot for a while after use. Ensure the engine and exhaust have cooled before carrying out any maintenance or storage.

- 4.0 Before stopping the machine, you must allow the engine to idle for 30 seconds.
- 4.1 Release the OPC Lever (1) and the engine will stop.

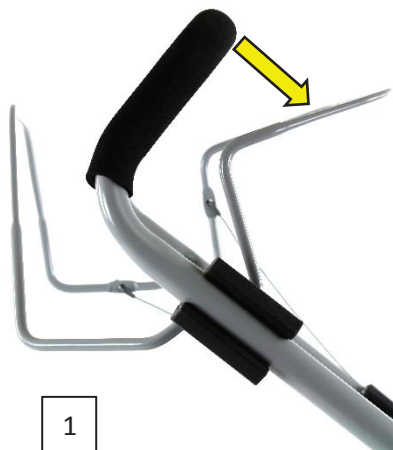

6. USING THE MACHINE

- 5.0 Always use the lawnmower with the grass catcher, or rear deflector in position.
- 5.1 Stop the engine before emptying the grass catcher or before you change the cutting height.
- 5.2 Never put feet or hands near the mower when running.
- 5.3 Before mowing, remove all foreign objects from the lawn, which may cause injury or damage.
- 5.4 Keep children, people and pets at a safe distance (at least 20m) when the lawnmower is in use.
- 5.5 Always wear appropriate Personal Protective Equipment (PPE) when using this machine. Suggested PPE: Sturdy footwear, work gloves (especially when working near blade), long trousers and hearing protection.
- 5.6 Never work barefooted or with open shoes or sandals.
- 5.7 Do not operate the engine in a confined space where dangerous carbon monoxide fumes can collect.
- 5.8 Mow only in daylight.
- 5.9 Avoid operating the equipment in wet grass.
- 5.10 Always be sure of your footing on slopes **WALK**, never run.
- 5.11 For wheeled rotary machines, mow across the face of slopes, never up and down. Exercise extreme caution when changing direction on slopes.
- 5.12 Do not mow excessively steep slopes.
- 5.13 Use extreme caution when reversing or pulling the lawn mower towards you, in case you slip and your feet go underneath the machine and in to the blade.
- 5.14 Stop the engine and allow the blade to come to a stop if the lawn mower has to be tilted for transportation when crossing surfaces other than grass, and when transporting the lawn mower to and from the area to be mowed.
- 5.15 Never operate the lawn mower with defective guards, or without safety devices, for example deflectors and/or grass catchers, in place.
- 5.16 Do not change the engine governor settings. If the engine speed is too high it will cause excessive wear, if too low it will not cut or pick up the grass effectively.
- 5.17 Ensure the self-propelled lever is released before starting the engine.

- 5.18 Start the engine carefully according to instructions and with feet well away from the blade.
- 5.19 Do not tilt the lawn mower when starting the engine.
- 5.20 Do not put hands or feet near or under rotating parts.
- 5.21 Never pick up or carry a lawn mower while the engine is running.
- 5.22 Before leaving the mower to clear blockages, check, clean, refuel or after striking foreign object - Stop the engine and make sure that the blades have come to a complete stop.
- 5.23 If the lawn mower starts to vibrate abnormally (check immediately).

7. MAINTENANCE



WARNING

NEVER touch a rotating blade.

Always stop the engine and unplug the spark plug before doing any repairs or maintenance.

Check regularly the oil level and keep it to the recommended level as required.

Frequently check the lawnmower and ensure that all grass deposits are removed from beneath the deck.

Lubricate the wheel bearings with a suitable lubricant.

Check the blade, in order to obtain a good cut, the blade should always be sharp and well balanced. At regular intervals, check the tightness of all nuts, bolts and screws.

If the blade hits an obstacle check for damage and if the machine vibrates badly stop the lawnmower and take it to a service dealer.



CAUTION

Always refuel in a well-ventilated area with the engine off.

Whilst carrying out maintenance you must wear appropriate Personal Protective Equipment (PPE) when using this machine.

Suggested PPE: Sturdy footwear, work gloves (especially when working near blade), long trousers and hearing protection.

THE BLADE

- 6.0 The blade. You **MUST** wear gloves to protect your hands from being cut when working with the blade.
- 6.1 The blade is made of pressed steel, in order to obtain a good cut, sharpen the blade frequently, typically around every 25 hours of work.
- 6.2 Following blade sharpening you must make sure that the blade is always well balanced.
- 6.3 To remove the blade, unscrew the bolt, check the blade carrier and all components, replace if they are worn or damaged.

THE SPARK PLUG

- 6.4 You **MUST** allow the engine to cool down before carrying out any maintenance.
- 6.5 Always replace with the same model spark plug as fitted.
- 6.6 To check spark plug, remove spark plug cap (1) and remove spark plug (2) using the supplied spark plug wrench.

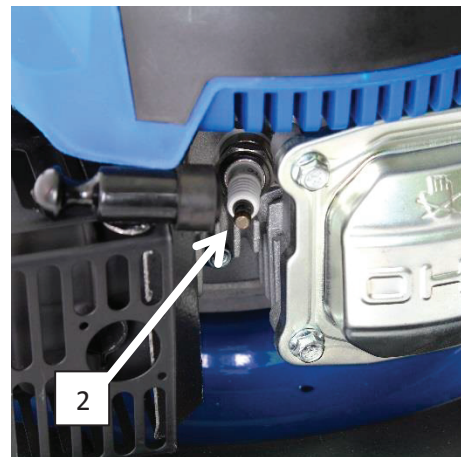
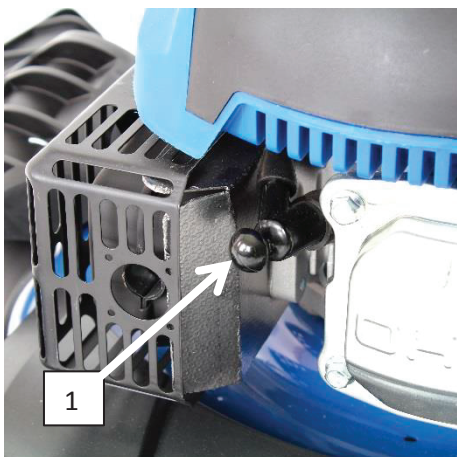

- 6.7 Clean the spark plug electrode, making sure that there is no damage to the insulator or electrode.
- 6.8 The spark plug gap should be 0.70mm to 0.80mm. Check the gap by using a feeler gauge. Adjust as necessary by carefully bending the side electrode to achieve the correct gap.

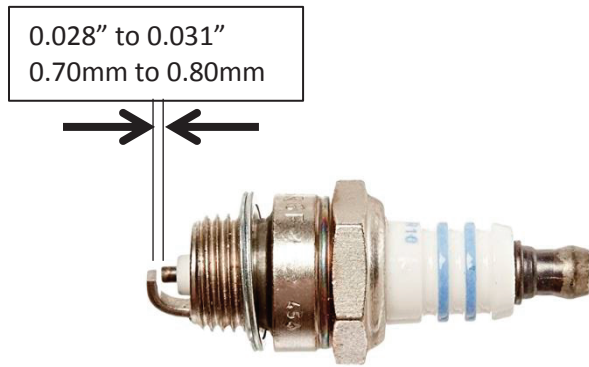

- 6.9 Refit the cleaned and adjusted spark plug by hand to avoid cross-threading.
- 6.10 After spark plug seats then tighten as necessary but avoid over-tightening.
- 6.11 Re-attach the spark plug cap.

AIR FILTER

CAUTION

A dirty air filter will restrict the air flow to the carburetor, which will reduce engine efficiency.

When using the lawnmower in very dusty areas you must clean or replace the air filter more often.

Never operate the machine without the air filter being fitted it can cause damage to the engine which is not covered by warranty.

- 6.12 To gain access to the air filter press the 2 latch tabs (1).
- 6.13 Remove filter (2), check for contamination and clean or replace as required.

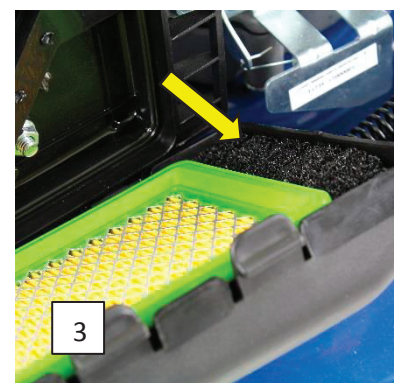
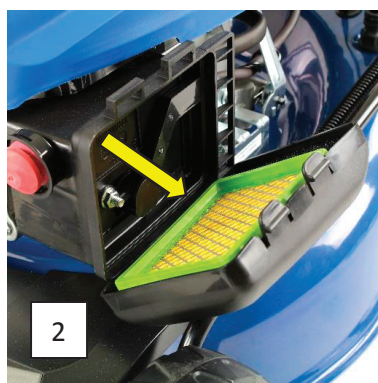
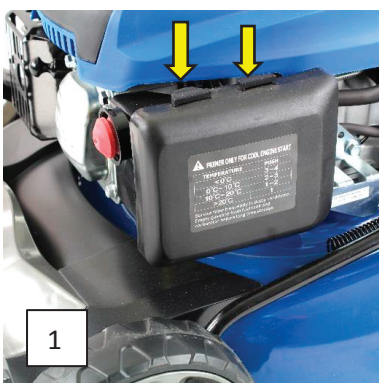

- 6.14 Clean the filter by blowing air through it using an air gun not exceeding 30psi.
- 6.15 Also clean the foam pre-filter (3). Wash in detergent and let dry.
- 6.16 Never use a brush to clean the filter it will only drive dirt into the fibres of the filter.
- 6.17 Wipe dirt from the air cleaner body by using a moist rag, be careful to prevent dirt or debris entering in to the carburetor.

FUEL AND CARBURETOR



CAUTION

ALL FUELS ARE FLAMABLE

ALWAYS fuel and defuel in a well ventilated area outside of buildings.

ALWAYS wear correct, suitable and fit for purpose Personal Protective Equipment (PPE), suggested items are but not limited to safety gloves, overalls.

- 6.18 The use of old or stale fuel will impair starting and running of the machine.
- 6.19 Make sure that the machine has fresh unleaded fuel and always remove fuel before storing for long periods.
- 6.20 Never mix fuel and oil.
- 6.21 To drain the carburetor float bowl (1) undo the drain bolt making sure that the washer is not lost.
- 6.22 Use a suitable container to catch fuel. Take care not to spill fuel and make sure that all spilt fuel is cleared away safely.

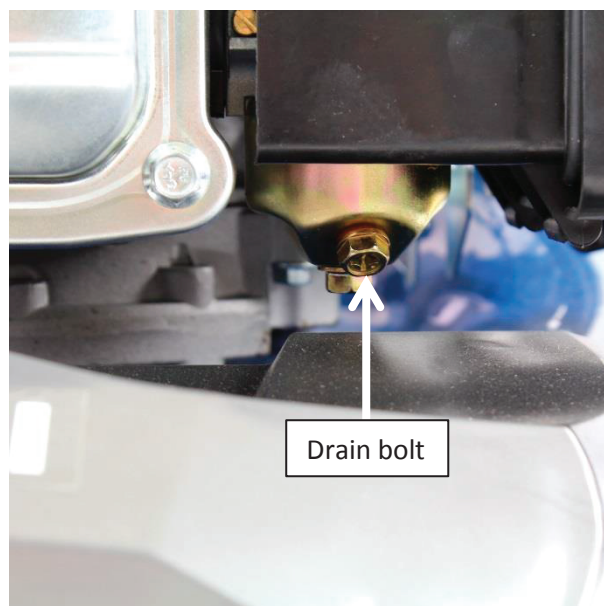

CLEANING



CAUTION

DO NOT use a hose pipe or pressure washer to clean the engine. Water can damage the engine or contaminate the fuel system.

- 6.23 Wipe the deck with a dry cloth.
- 6.24 You can hose under deck by tilting the mower. Make sure you tilt the machine so that the air filter is facing up. **NOTE** Engine must be switched off and plug lead disconnected.
- 6.25 Dry the machine completely to prevent any rust forming. You can use a light oil or silicone spray to prevent rust.

STORAGE



NOTE

When storing the machine, make sure it has been cleaned as in section 6.23. You can use a light oil or silicone spray to coat the equipment.

- 6.26 The following steps should be taken to prepare your lawnmower for storage.
- 6.27 After the final cut of the season – you must drain the fuel from the fuel tank. Then run the machine until the engine comes to a stop this allows the carburetor to be emptied of fuel.
- 6.28 Clean the mower completely and make sure all moving parts are lubricated.
- 6.29 Check the blade to make sure that it is ready for the following season – This will allow you to get it sharpened correctly. Use a light oil or silicone spray to help prevent the blade from rusting.
- 6.30 Drain engine oil and replace with new SAE15w40 engine oil, fill to the upper mark on the dipstick.
- 6.31 Once all work above is carried out store the machine in a clean and dry place. **DO NOT** store a machine that has not been given time to fully cool down.

8. TROUBLE SHOOTING



NOTE

Where necessary, all corrective actions should be carried out by suitably qualified persons.

- 7.0 If the starter rope becomes disconnected from the rope guide on handle, disconnect the spark plug cap.
Pull the starter rope out from engine slowly and re-engage in guide. Re connect spark plug cap.

| Problem | Possible Cause | Possible Corrective Action |
|---|--|--|
| Engine does not start | OPC cable not adjusted correctly | Adjust OPC cable |
| | Fuel tank is empty | Fill fuel tank |
| | Stale fuel | Drain carburetor float bowl |
| | Air filter element is dirty | Clean or replace air filter |
| | Spark plug is loose | Tighten spark plug |
| | Spark plug cap loose or disconnected | Correctly fit the spark plug cap |
| Spark plug faulty | Spark plug gap is incorrect | Set plug gap to 0.7 – 0.8mm or Replace spark plug |
| | Carburetor is flooded with fuel | Remove the air filter and pull starter rope until carburetor clears |
| | Faulty ignition module | Contact the service dealer |
| Engine difficult to start or loses power | Dirt, water or stale fuel in tank | Drain fuel and clean tank Fill with clean, fresh fuel |
| | Vent hole in fuel tank is clogged | Clean or replace fuel tank cap |
| | Air filter element is dirty | Clean or replace air filter element |
| Engine operates erratically | Spark plug is defective | Fit new, correctly gapped spark plug |
| | Spark plug gap is incorrect | Set plug to 0.7 – 0.8mm |
| | Air filter element is dirty | Clean or replace air filter element |
| Engine idles poorly | Air filter element is dirty | Clean or replace air filter element |
| | Air slots in engine are blocked | Remove debris from slots |
| | Cooling fins and air passages under engine housing are blocked | Remove debris from cooling fins and passages |
| Engine skips at high speed | Spark plug electrode gap is incorrect | Set plug gap to 0.7 – 0.8mm |
| Engine Overheating | Cooling airflow is restricted | Remove any debris from slots in shroud, blower housing, air passages |
| | Incorrect spark plug | Fit new spark plug |
| Mower vibrates abnormally DO NOT use the machine until vibration issue has been fixed | Cutting assembly is loose | Tighten blade |
| | Blade/cutting assembly is unbalanced | Take to a service dealer |

9. SPECIFICATION

| MODEL | HYM430SP | HYM460SP | HYM510SP |
|------------------------|---------------------------------------|---|---|
| Engine Type | IC140V | IC140V | IC175V |
| Engine Size – cc | 139 | 139 | 173 |
| Fuel Tank Capacity - L | 1 | 1 | 1 |
| Fuel Type | Straight – Unleaded Petrol | | |
| Oil Capacity – ml | 0.6 | 0.6 | 0.6 |
| Rated Speed – rpm | 2800 | 2800 | 2800 |
| Rated Power – kw | 2.6 | 2.6 | 3.6 |
| Drive Type | Self-propelled | Self-propelled 4 in 1 | Self-propelled 4 in 1 |
| Start Method | Recoil Start | | |
| Height Adjustment | 6 position | | |
| Cutting Height - mm | 25-75mm | | |
| Cutting Width – mm | 420 | 457 | 508 |
| Catcher Type | Half Plastic with polyester bag | | |
| Catcher Volume | 45 | 70 | 70 |
| Deck Material | Steel | | |
| Wheel Size Front – mm | 152 | 178 | 203 |
| Wheel Size Rear – mm | 178 | 254 | 280 |
| Handle Type | Soft Grip Handle | | |
| Function | Rear discharge Mulching Collect | Rear discharge Mulching Side discharge Collect | Rear discharge Mulching Side discharge Collect |



NOTE

All machines are pre delivery inspected so there may be some residual oil left in the machine so please fill with caution.

10. CONTACT DETAILS

| | | |
|-----|------------------|---|
| 9.0 | POSTAL ADDRESS | PO Box 9117, Newmarket, Auckland 1149, New Zealand |
| 9.1 | TELEPHONE FAX | +0800 800 880 |
| 9.2 | TECHNICAL EMAIL | support@tradetested.co.nz |
| 9.3 | WEBSITE | www.tradetested.co.nz |

11. WARRANTY

For warranty information please visit www.tradetested.co.nz

MANUAL UPDATES

- 10.0 Our manuals are constantly being reviewed and updated. However if you find an error, omission or something you find unclear, please contact your dealer for assistance.
- 10.1 Our latest manuals are also placed online.
- 10.2 We reserve the right to make any modifications without prior notice whenever necessary.

HYUNDAI
POWER PRODUCTS

For Inquires, Please Contact:

Trade Tested Limited
PO Box 9117, Newmarket, Auckland 1149, New Zealand
0800 800 880
support@tradetested.co.nz
www.tradetested.co.nz